

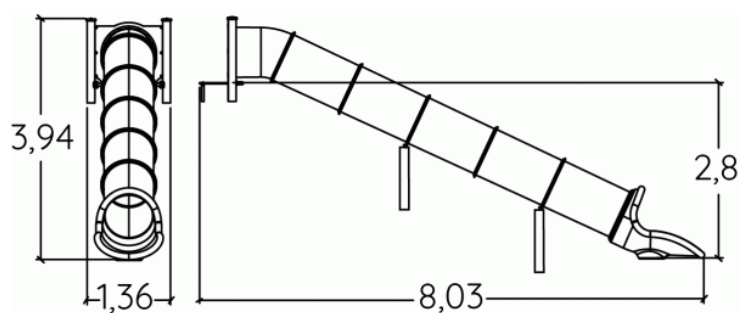

1 = 8,03m
2 = 1,36m
3 = 3,94m

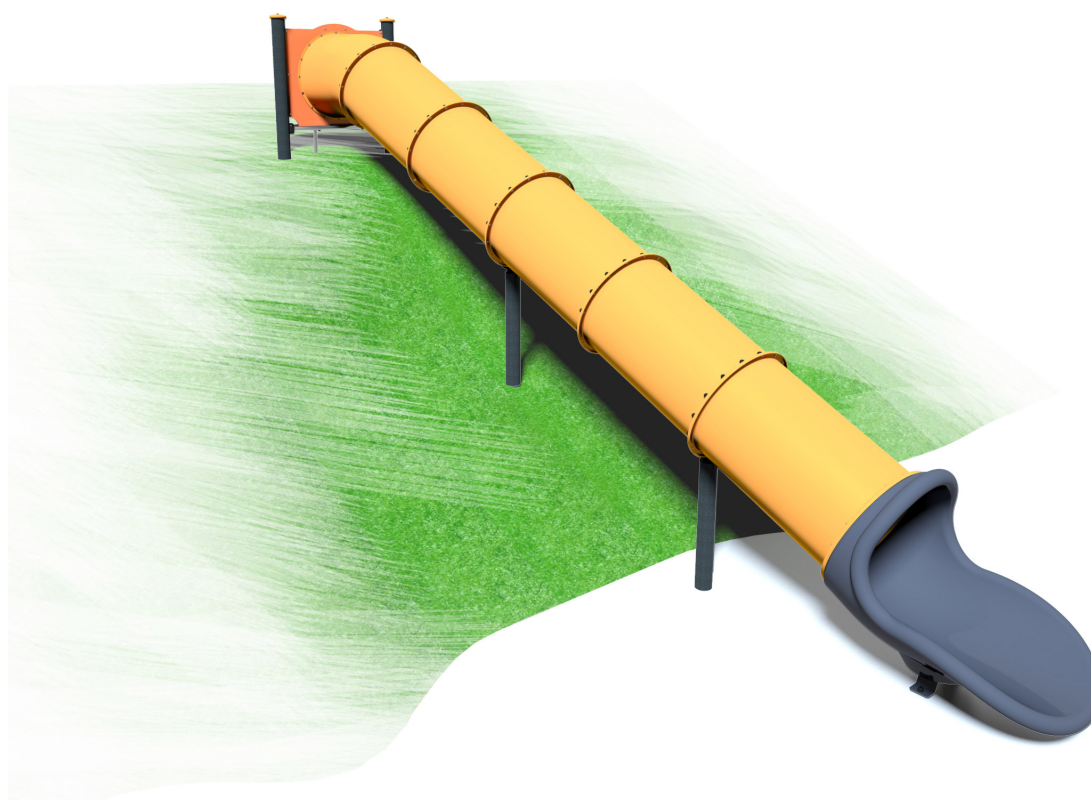

Physical inclusion
Sensory inclusion
Cognitive inclusion



Play value : 3

sliding



x1

meeting



x1

hiding



x1

Installation of equipment

IMPORTANT: It is essential to refer to the installation instructions for information on the size of the safety areas.

— Impact area (minimum normative surface)

- - - Free space

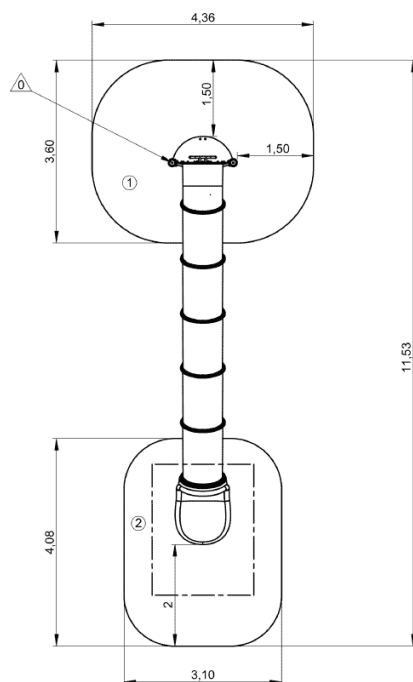

1	0,6m	14m ²
2	1m	12m ²



2



05h00



0.2m³



26m²



252kg



41kg

