



5+



11



2,4m



1 = 3,51m
2 = 2,39m
3 = 2,44m



Physical inclusion
Sensory inclusion
Cognitive inclusion

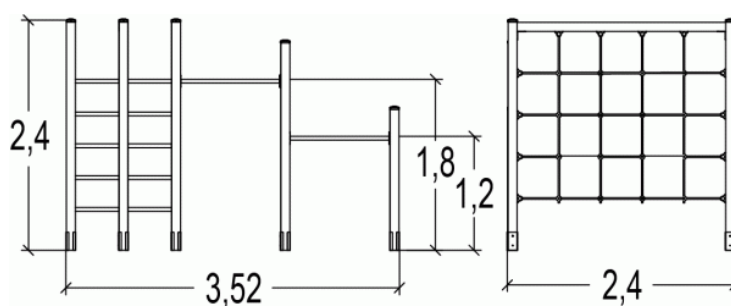

Play value : **8**

hanging



x2

balancing



x2

climbing



x3

getting across



x1

Components

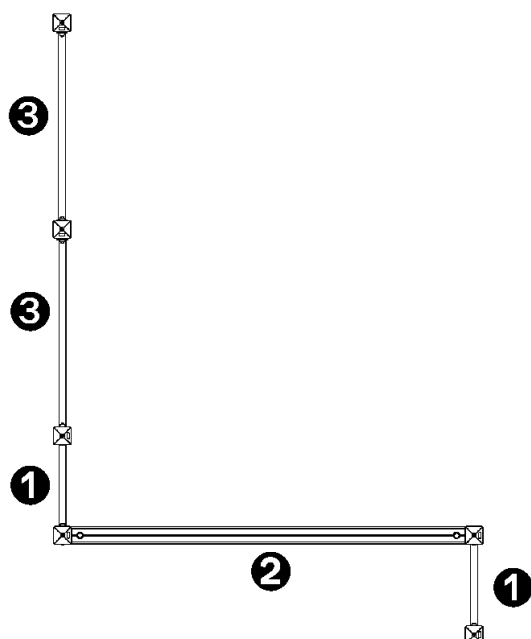

- ❶ Echelle verticale
- ❷ Net
- ❸ Horizontal bar

Installation of equipment

IMPORTANT: It is essential to refer to the installation instructions for information on the size of the safety areas.

- Impact area (minimum normative surface)
- Free space

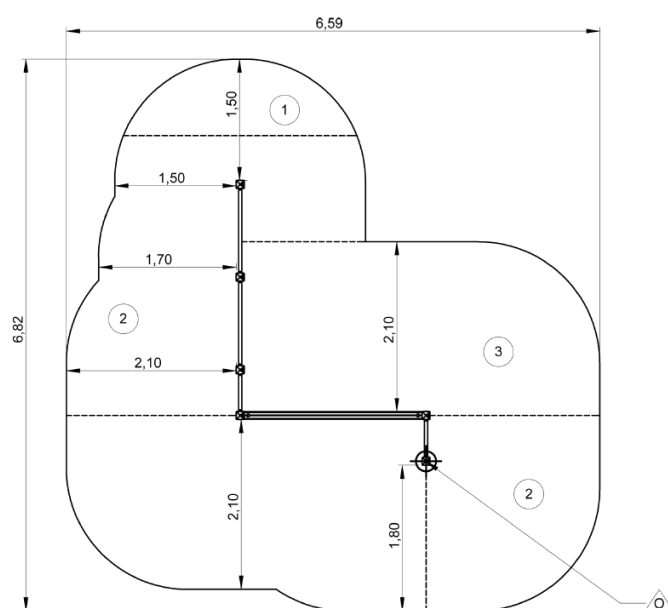

1	1,2m	2m ²
2	1,95m	13,5m ²
3	2,4m	18,5m ²



2

03h00

0.2m³

34m²

163kg

20kg

EN
1176