

Physical inclusion  
Sensory inclusion  
Cognitive inclusion

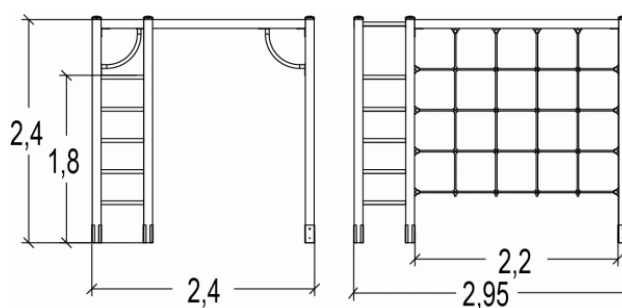

**Play value :** **10**

balancing



x4

climbing



x5

getting across



x1

## Components

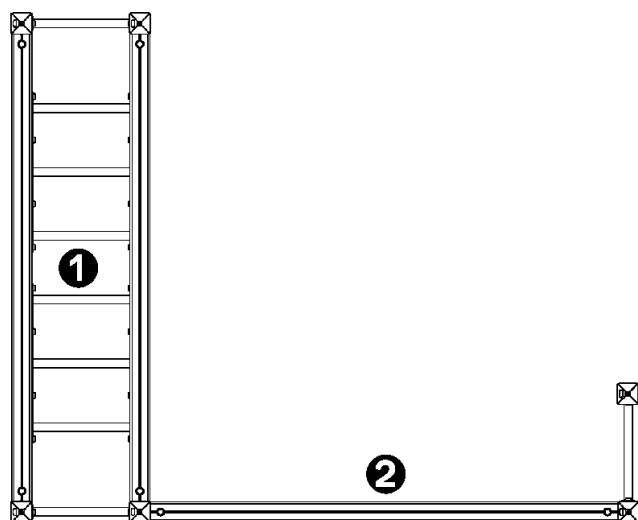

- ❶ Echelle verticale
- ❷ Net

## Installation of equipment

**IMPORTANT:** It is essential to refer to the installation instructions for information on the size of the safety areas.

- Impact area (minimum normative surface)
- Free space

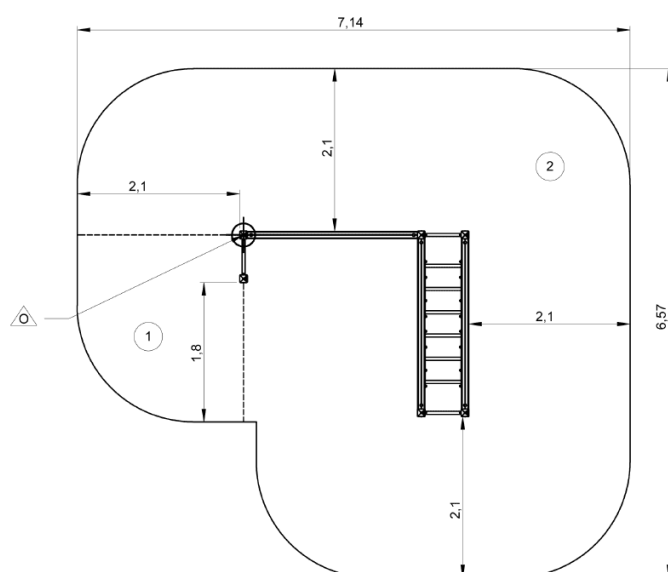

1	1,8m	5m <sup>2</sup>
2	2,4m	36m <sup>2</sup>



2

04h15

0.2m<sup>3</sup>

40m<sup>2</sup>

226kg

20kg

EN

1176