



6+



17



2,4m



1 = 7,97m

2 = 4,8m

3 = 3,3m



Physical inclusion

Sensory inclusion

Cognitive inclusion

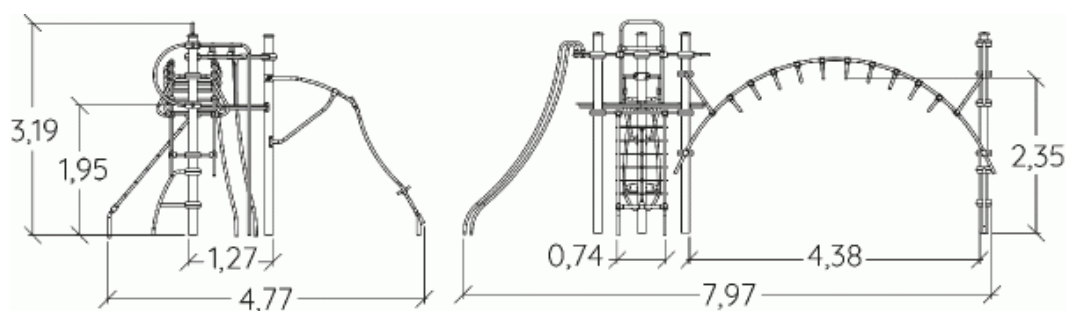

Play value :

9

sliding



x2

meeting



x1

hanging



x1

balancing



x1

rotating



x1

climbing



x2

getting across



x1

## Components

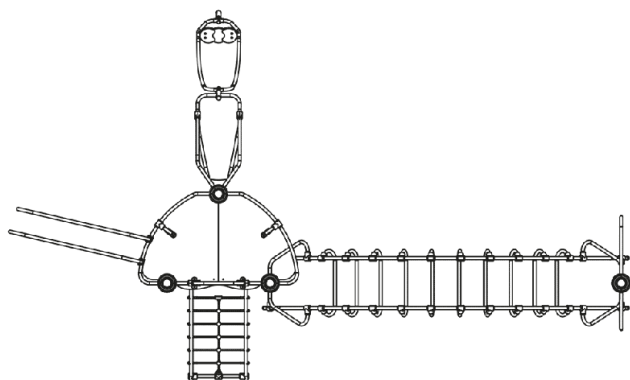

- ❶ Tour Gamma
- ❷ Great arch
- ❸ Parrot mast
- ❹ Incline net
- ❺ Speed slide
- ❻ Gyro

## Installation of equipment

**IMPORTANT:** It is essential to refer to the installation instructions for information on the size of the safety areas.

- Impact area (minimum normative surface)
- - - Free space

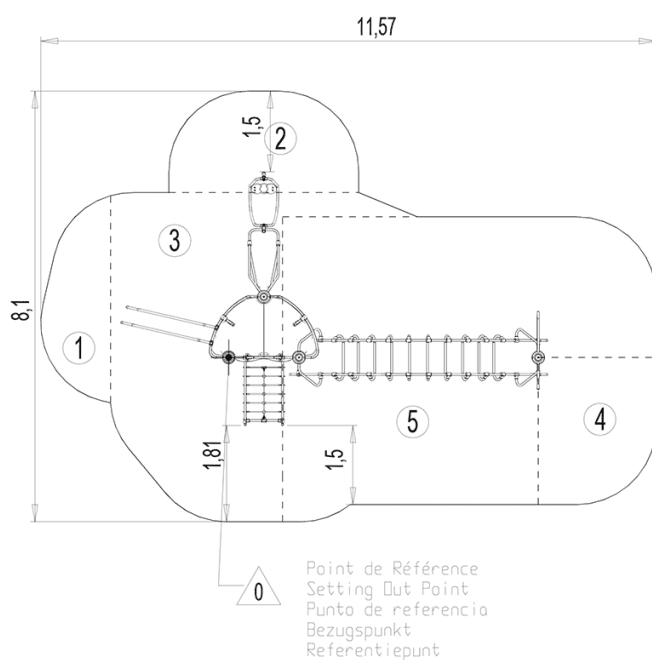

1	0,6m	4m <sup>2</sup>
2	0,7m	6m <sup>2</sup>
3	1,95m	20m <sup>2</sup>
4	2m	6m <sup>2</sup>
5	2,4m	32m <sup>2</sup>



2

17h00

0.4m<sup>3</sup>

68m<sup>2</sup>

295kg

53kg

EN  
1176