



2+



14



1,5m



1 = 2,12m  
2 = 0,98m  
3 = 1,45m



Physical inclusion  
Sensory inclusion  
Cognitive inclusion

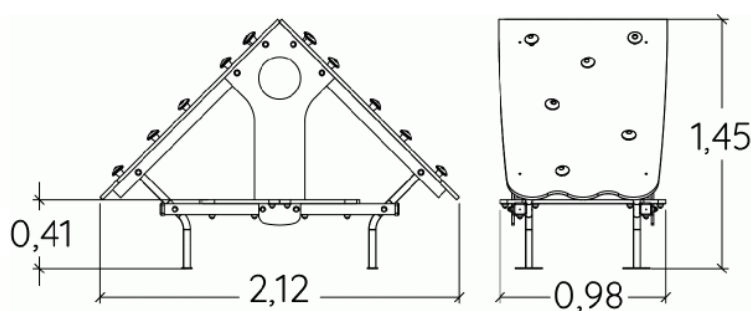

Play value :

6

climbing



x1

role play



x1

meeting



x1

resting



x1

hiding



x1

taking shelter



x1

## Installation of equipment

**IMPORTANT:** It is essential to refer to the installation instructions for information on the size of the safety areas.

 Impact area (minimum normative surface)

 Free space

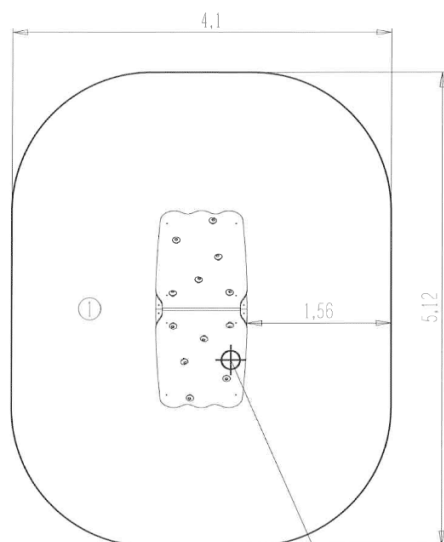

Point de Référence  
Setting Out Point  
Punto de referencia  
Bezugspunkt



1	1,50m	19m <sup>2</sup>
---	-------	------------------



2

01h50

0.1m<sup>3</sup>

19m<sup>2</sup>

110kg

23kg

EN  
1176