



6+



14



1,95m



1 = 4,8m
2 = 4,1m
3 = 3,3m



Physical inclusion
Sensory inclusion
Cognitive inclusion

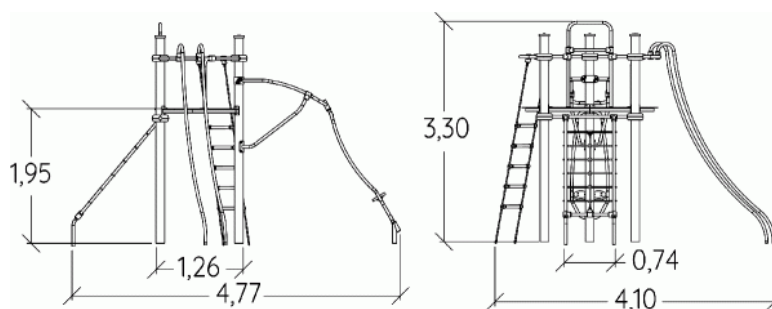

Play value : 7

sliding



x1

meeting



x1

balancing



x2

rotating



x1

climbing



x2

Components

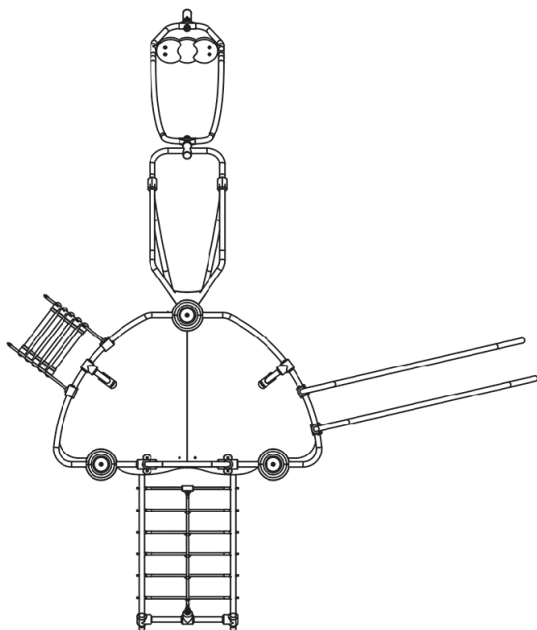

- ❶ Tour Gamma
- ❷ Gyro
- ❸ Incline net
- ❹ Rope ladder
- ❺ Speed slide

Installation of equipment

IMPORTANT: It is essential to refer to the installation instructions for information on the size of the safety areas.

- Impact area (minimum normative surface)
- - - Free space

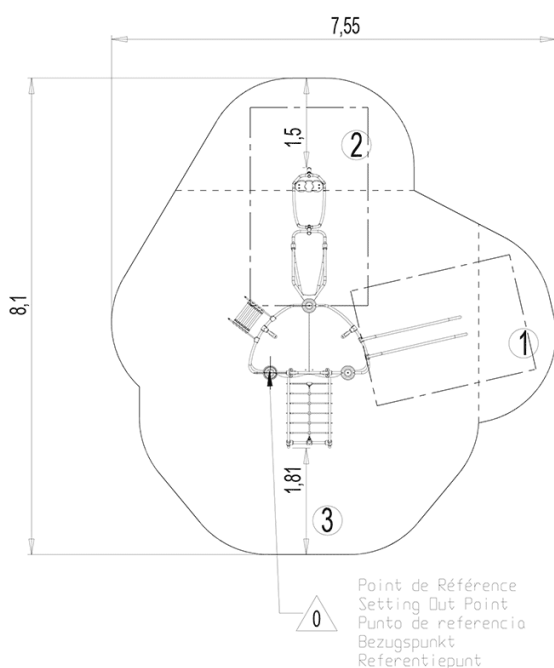

1	0,6m	3,5m ²
2	0,7m	6m ²
3	1,95m	33,5m ²



2

16h00

0.7m³

43m²

202kg

15kg

EN
1176