



2+



25



1,37m



1 = 9,2m
2 = 6,72m
3 = 3,22m



Physical inclusion
Sensory inclusion
Cognitive inclusion

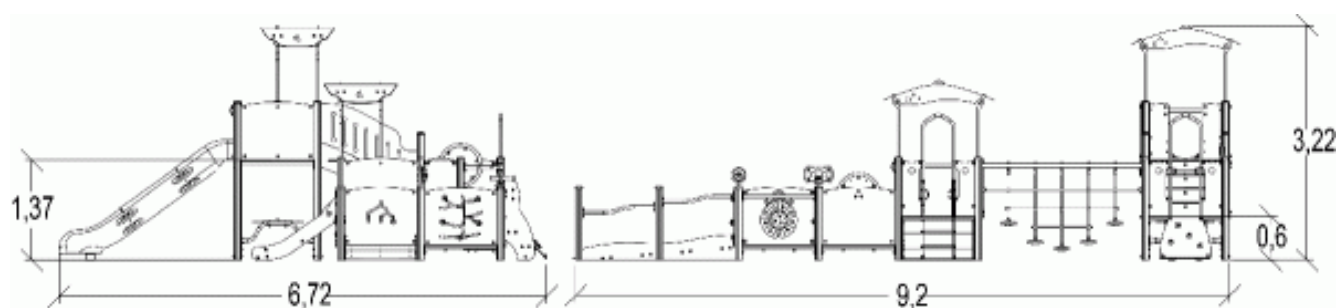

Play value : **72**

climbing	role play	sliding	meeting	resting	handling	hiding	balancing
x1	x10	x2	x10	x2	x13	x1	x1
taking shelter	thinking	tactile stimulation	visual stimulation	climbing	getting across		
x2	x7	x13	x4	x4	x2		

Components

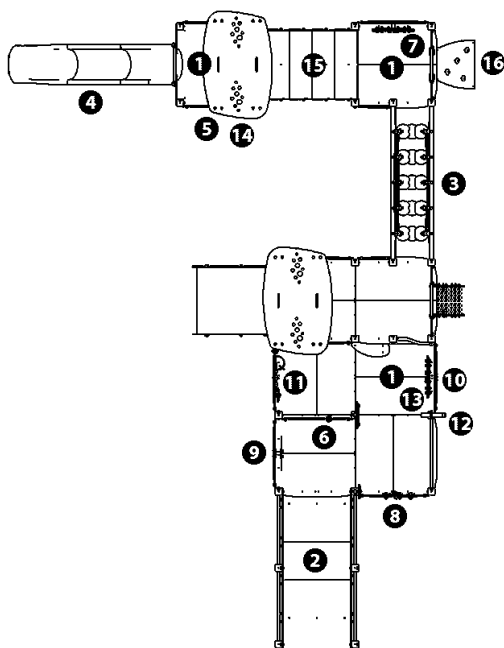

- ❶ Square platform
- ❷ Access ramp
- ❸ Floating steps
- ❹ Polyethylene slide H: 1.37m
- ❺ Play table
- ❻ 'Maze' board
- ❼ Pinball panel
- ❽ Flower panel
- ❾ Lottery Panel
- ❿ The Pachinko Play Panel
- ⓫ Triple play panel
- ⓬ Telescope
- ⓭ Coloured binoculars
- ⓮ Spinning disc
- ⓯ Steps
- ⓰ Slope

Installation of equipment

IMPORTANT: It is essential to refer to the installation instructions for information on the size of the safety areas.

- Impact area (minimum normative surface)
- - - Free space

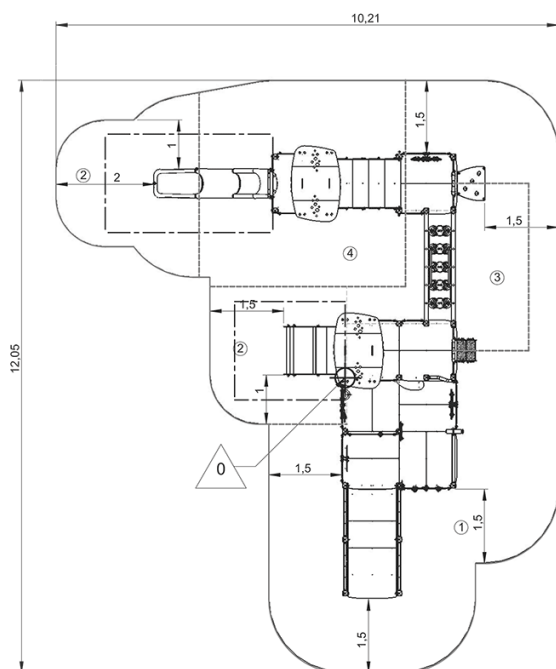

1	0,6m	41m ²
2	1m	16m ²
3	1,3m	8,5m ²
4	1,37m	17,5m ²



3

55h00

0.96m³

83m²

1359kg

29kg

EN
1176