

Play value : **2**

climbing



x2

Installation of equipment

IMPORTANT: It is essential to refer to the installation instructions for information on the size of the safety areas.

— Impact area (minimum normative surface)
- - - Free space

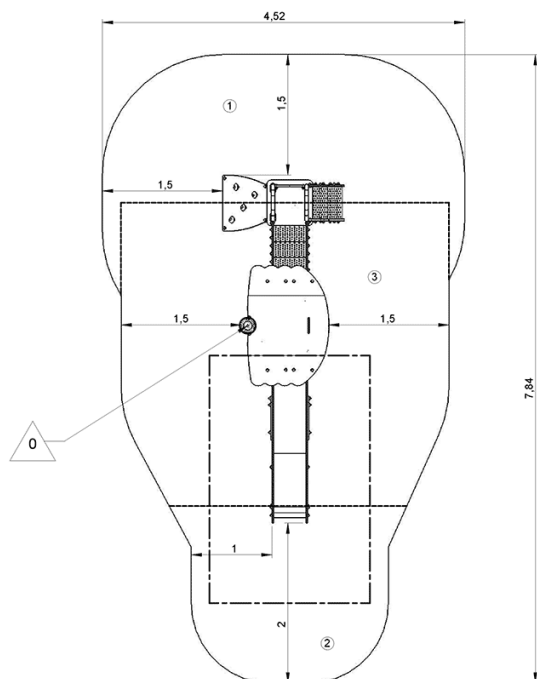

1	0,6m	8m ²
2	1m	5,5m ²
3	1,17m	15m ²



2

18h00

0.2m³

0m²

290kg

32kg

EN
1176