

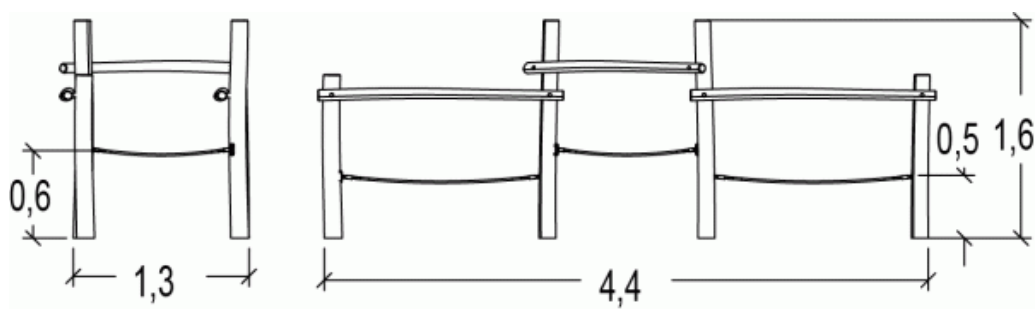

1 = 4,4m  
2 = 1,3m  
3 = 1,6m

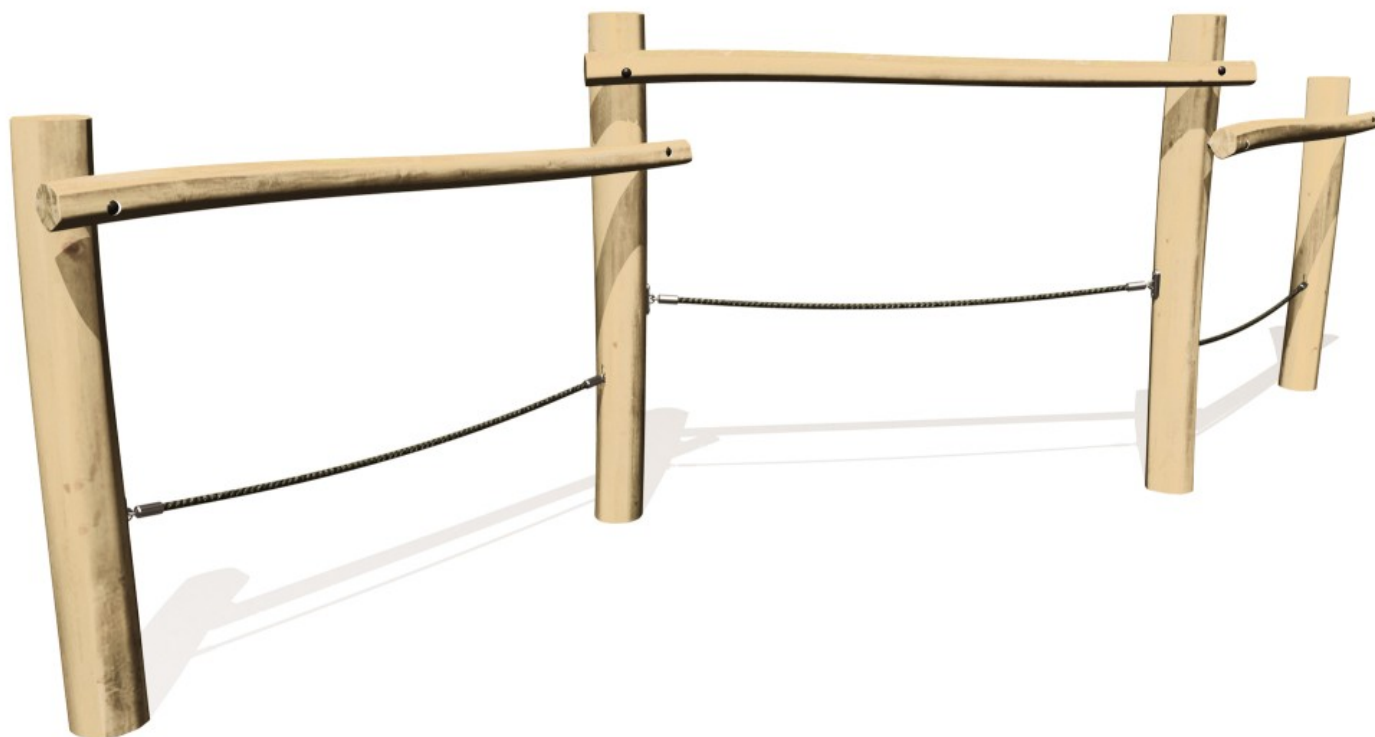

Physical inclusion  
Sensory inclusion  
Cognitive inclusion



**Play value :** **2**

balancing getting across



x1



x1

## Components

### 1 Walkway

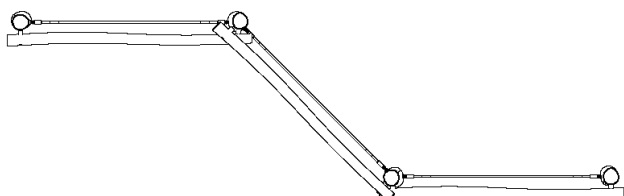

## Installation of equipment

**IMPORTANT:** It is essential to refer to the installation instructions for information on the size of the safety areas.

- Impact area (minimum normative surface)
- Free space

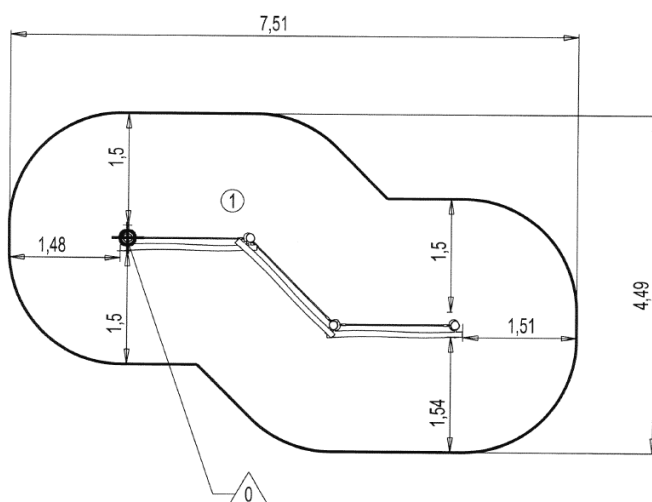

Point de Référence  
Setting Out Point  
Punto de referencia  
Bezugspunkt



1	<0,6m	25m <sup>2</sup>
---	-------	------------------



2



02h00



0.27m<sup>3</sup>



25m<sup>2</sup>



111kg



25kg

EN

1176