

Play value : 1

hanging



x1

Components

1 Horizontal bars

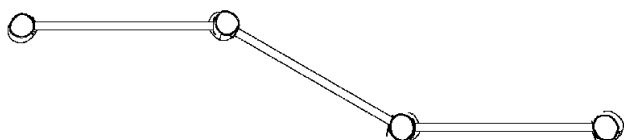



Installation of equipment

IMPORTANT: It is essential to refer to the installation instructions for information on the size of the safety areas.

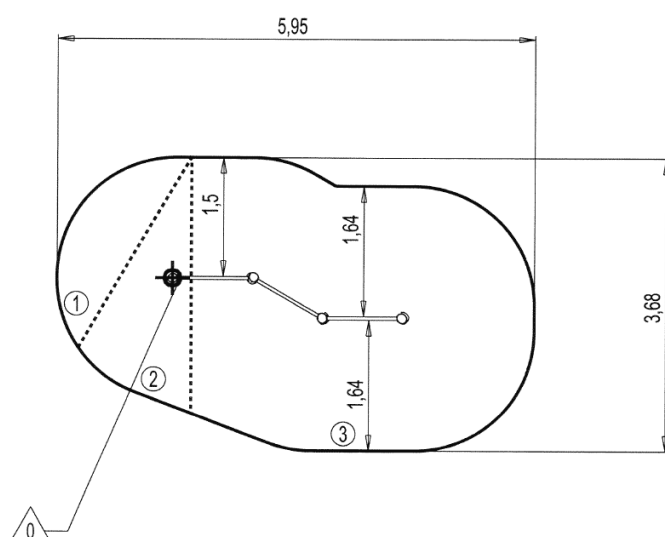
- Impact area (minimum normative surface)
- Free space



Point de Référence
Setting Out Point
Punto de referencia
Bezugspunkt

		
1	1m	2m ²
2	1,4m	2,5m ²
3	1,7m	13,5m ²



2



01h00



0.26m³



18m²



111kg



29kg

