



5+



55



2,16m



1 = 17,6m
2 = 8,59m
3 = 8,65m



Physical inclusion
Sensory inclusion
Cognitive inclusion

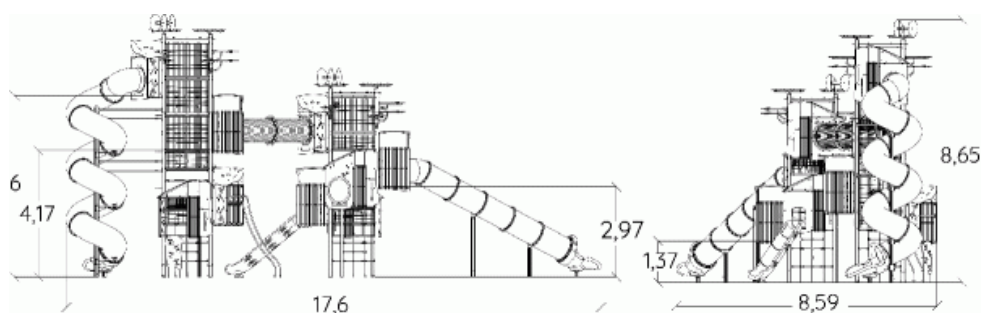

Play value : **58**

climbing	role play	sliding	meeting	resting	crawling	hiding	balancing
x1	x2	x5	x2	x10	x1	x11	x2
taking shelter	sound stimulation	tactile stimulation	visual stimulation	climbing	getting across		
x12	x1	x1	x5	x2	x3		

Components

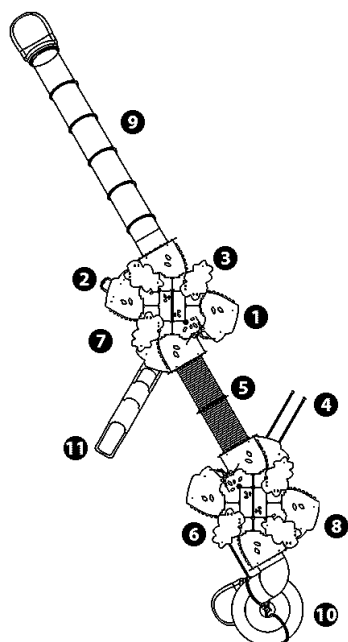

- ❶ Play porthole
- ❷ Fireman's pole
- ❸ Butterfly play panel
- ❹ Speedslide
- ❺ Polyethylene tunnel
- ❻ Climbing wall Ht: 1.37m
- ❼ Tower 6m / 5 platforms
- ❽ Tower 8m / 5 platforms
- ❾ Polyethylene slide Ht : 2.97m
- ❿ Polyethylene slide Ht : 5.97m
- ⓫ Slide Ht : 1.77m

Installation of equipment

IMPORTANT: It is essential to refer to the installation instructions for information on the size of the safety areas.

- Impact area (minimum normative surface)
- - - - - Free space

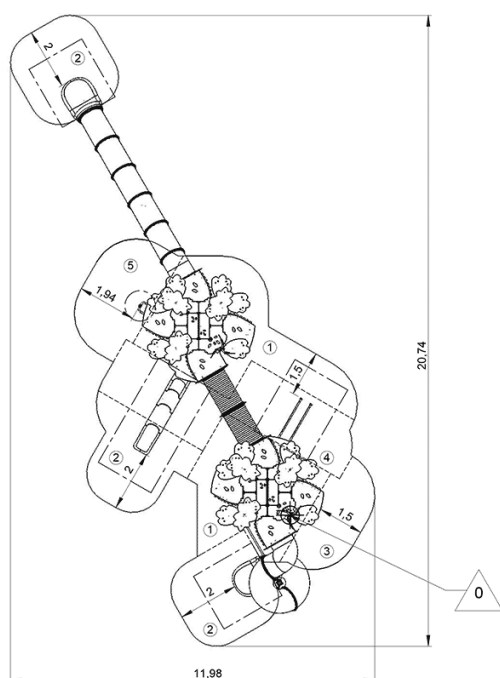

1	0,60m	32m ²
2	1,00m	27m ²
3	1,37m	6,5m ²
4	1,77m	16m ²
5	2,16m	12m ²



3

55h00

2.5m³

93.5m²

5261kg

78kg



EN

1176