

Physical inclusion
Sensory inclusion
Cognitive inclusion

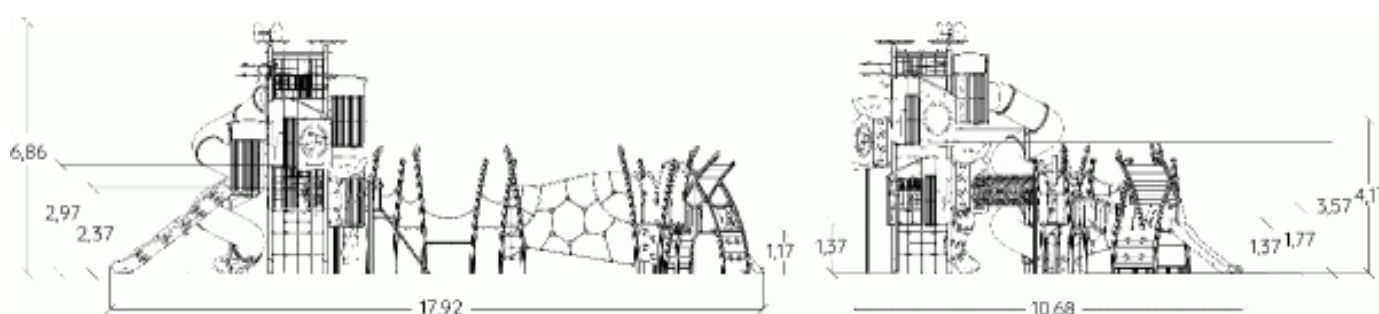

Play value : **62**

climbing

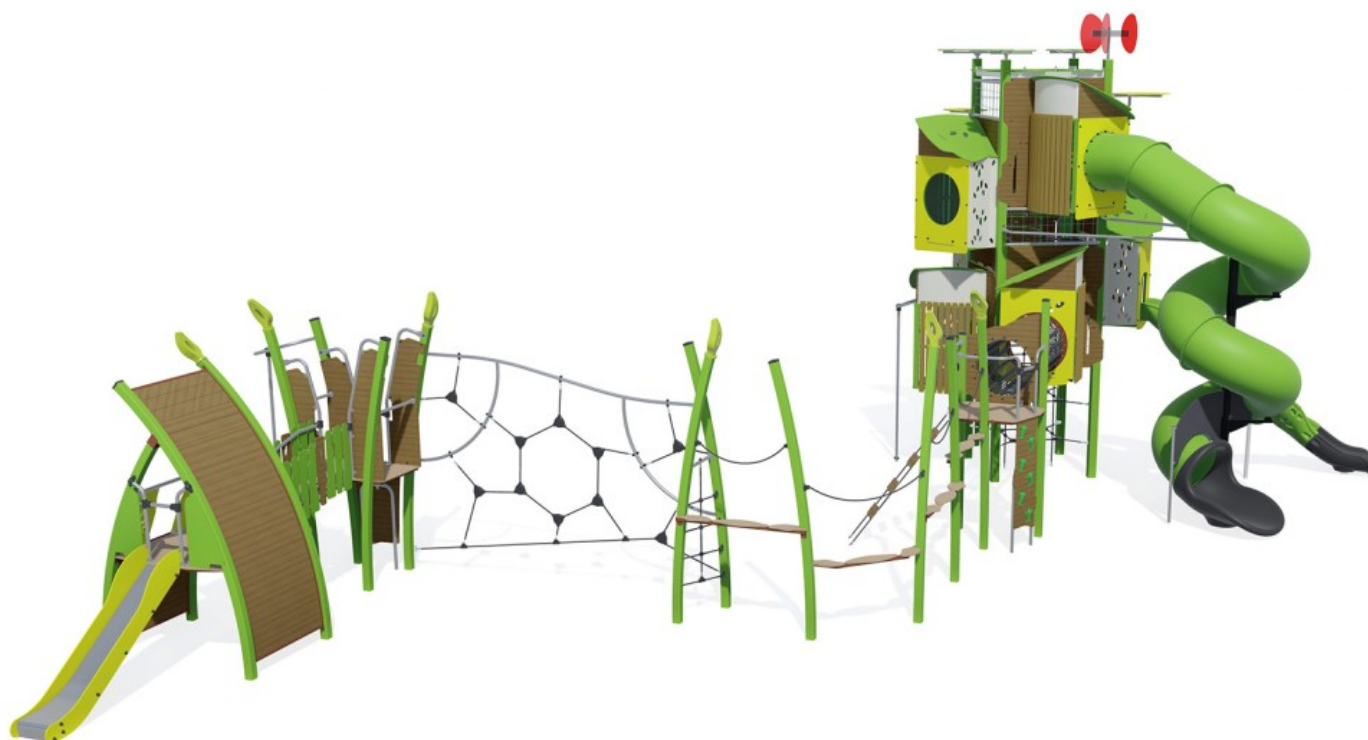

x3

role play



x1

sliding



x5

meeting



x4

resting



x6

handling



x1

crawling



x4

hiding



x7

balancing



x3

taking shelter



x8

thinking



x1

sound stimulation



x1

tactile stimulation



x2

visual stimulation



x4

climbing



x4

getting across



x8

Components

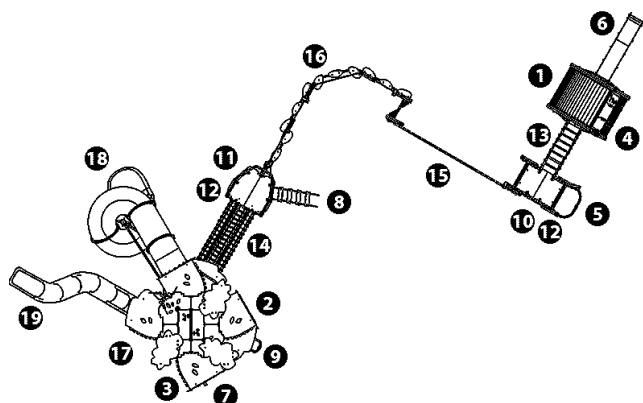

- ❶ Platform H: 1.17m
- ❷ Play porthole
- ❸ Play panel
- ❹ Climbing wall H: 1.7m
- ❺ Fireman's pole
- ❻ Slide Ht : 1.17m
- ❼ Butterfly play panel
- ❽ Net ladder
- ❾ Fireman's pole
- ❿ Platform with no roof, Ht: 1,37m
- ⓫ Platform with no roof, Ht: 1,77m
- ⓬ Climbing wall
- ⓭ Tilted bridge
- ⓮ Net tunnel
- ⓯ Spider web net
- ⓰ Pathway
- ⓱ Tower 6m / 6 platforms
- ⓲ Polyethylene slide Ht : 4.17m
- ⓳ Slide Ht : 2.37m
- ⓴

Installation of equipment

IMPORTANT: It is essential to refer to the installation instructions for information on the size of the safety areas.

- Impact area (minimum normative surface)
- Free space

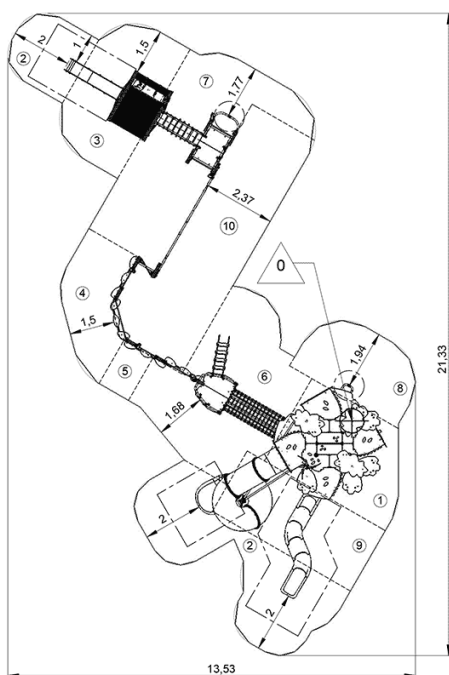

1	0,6m	13,5m ²
2	1m	23,5m ²
3	1,17m	13m ²
4	1,29m	8m ²
5	1,58m	2m ²
6	1,77m	21,5m ²
7	1,9m	10m ²
8	2,16m	9m ²
9	2,37m	12,5m ²
10	2,8m	35m ²



3

52h00

2m³

148m²

3838kg

78kg



EN

1176